

Shower Filter User's Manual

Compact Shower Filter & Slim Line Shower Filter

I. Products Function

1. De-chlorination & Decontamination—Prevent Skin from Aging and Eliminate Secondary Pollution from Tap Water.

1) Chlorine is a strong oxidant which may easily oxidize the skin keratoderma protein, causing itching and various skin ailments. Active carbon & KDF-55 have extraordinary de-chlorination functions and thus can keep our skin free from chlorination.

II Installation Instructions

1. Working Conditions



! Please check to make sure the installation is OK.

! Apply to normal water pressure

! Apply to standard tap water resources.

- 1. Before using the product, please remember to allow water to flow for about 10 seconds before getting under the water, this is to initially flush the shower filter and ensure clean fresh water every time.**
- 2. Maximum temperature should not be over 80° C**
- 3. Minimum temperature should not be below 4° C**

2. Product Installation Approach

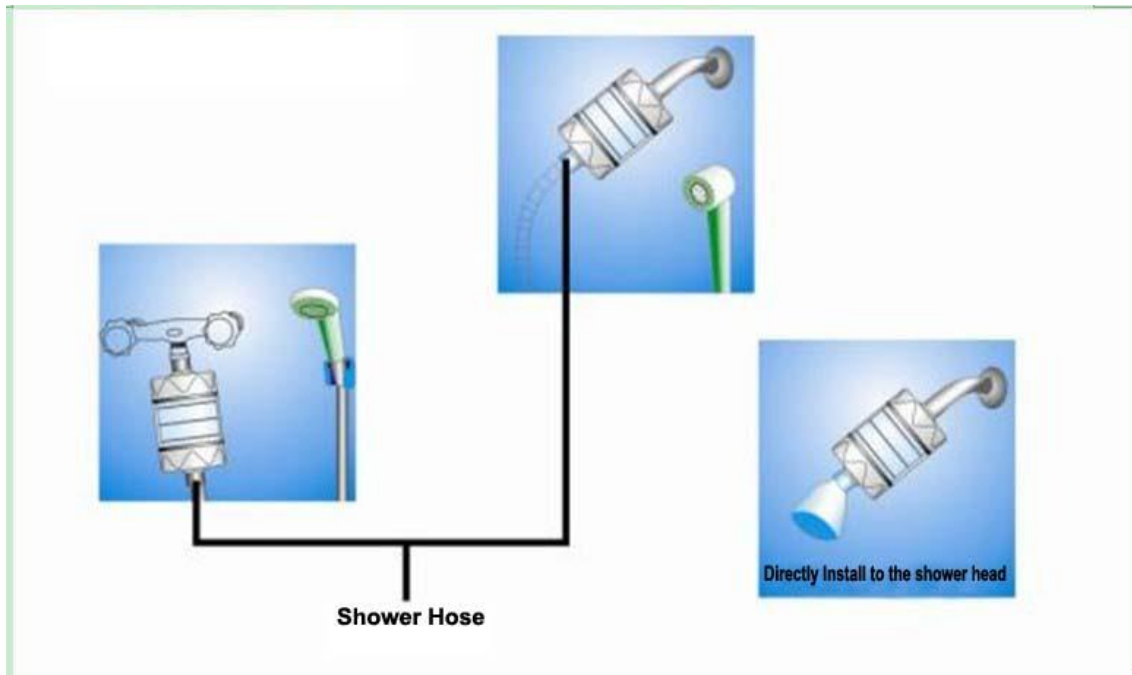

3. Filter Replacement

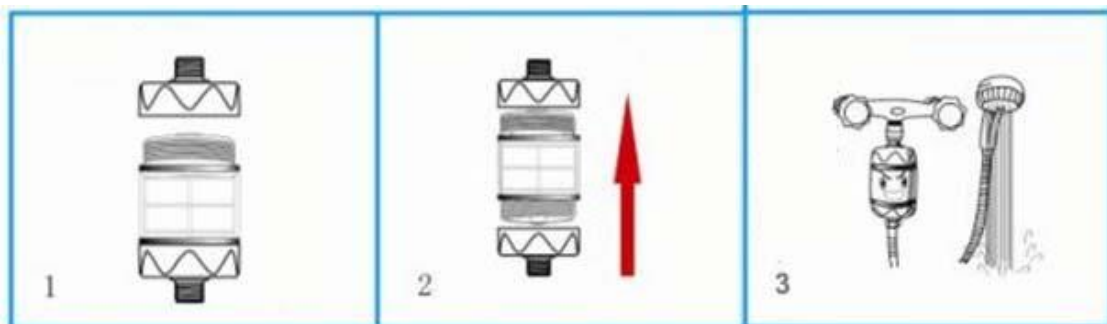

1. Grab hold of both ends of the filter and twist in an anti-clockwise direction.
2. This will open both halves.
2. Take out Filter.
3. Reinstall, flush water through the new filter for at least 20 seconds. Then the replacement is finished.